

Computer and Canvas Login Reset

**PLEASE NOTE changing your Computer Login Password will also affect your CANVAS password*

Click [HERE](#) to access directions on how to reset your password using a computer

Using an iPad

1. Open the Classlink app on your iPad and login using your existing computer login.



2. Select the 3 horizontal lines in the upper left of your screen.

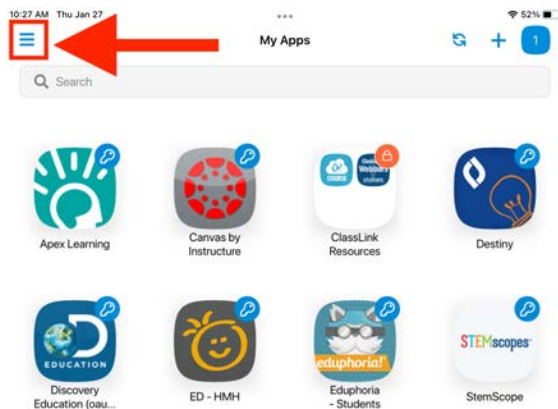

3. Select **Settings**

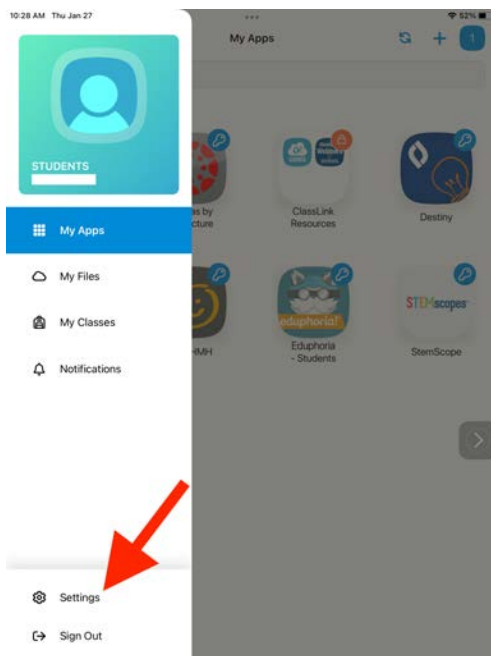

4. Select **Reset Password**

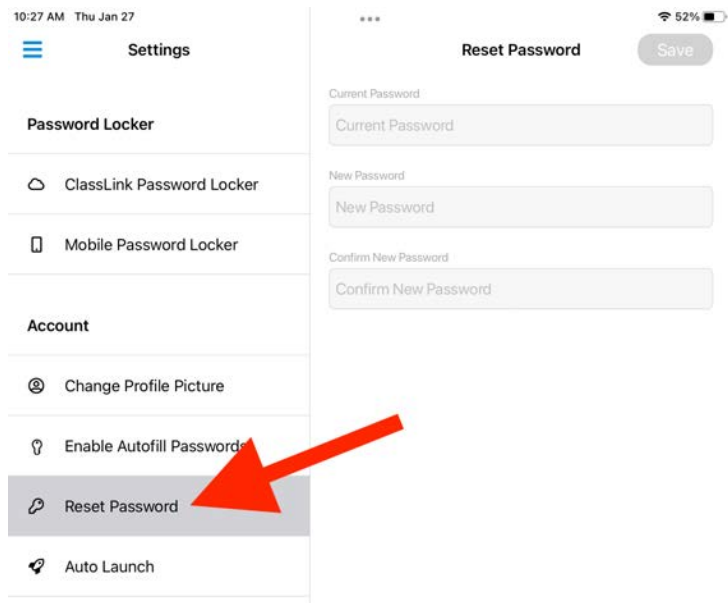

5. Type in your old password and then type in your new password, **Select Save**.

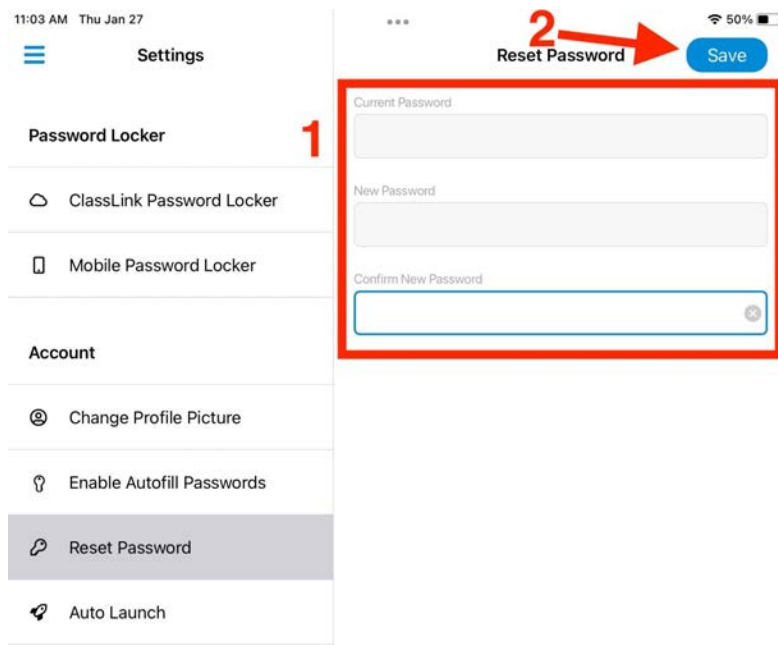

6. Log out of your Canvas account then log back in using your new password.

Logging into Canvas

1. Open the Canvas app Select 'Find my School'
2. Type in **nbisd** and then select Go
3. Type in your Username (studentID) and your **NEW** Password

Computer and Canvas Login Reset

**PLEASE NOTE changing your Computer Login Password will also affect your CANVAS password*

Using a Computer

1. Go to launchpad.classlink.com/nbisd and login using your existing computer login.

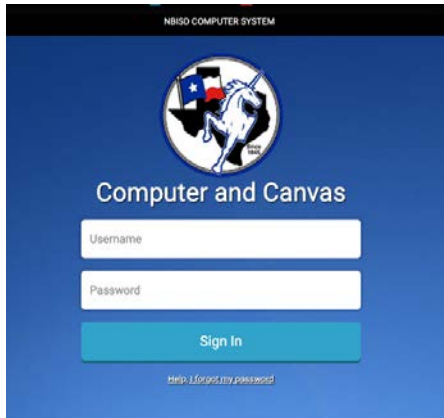

2. Select the arrow at the top right, beside your profile icon, then select **My Profile**

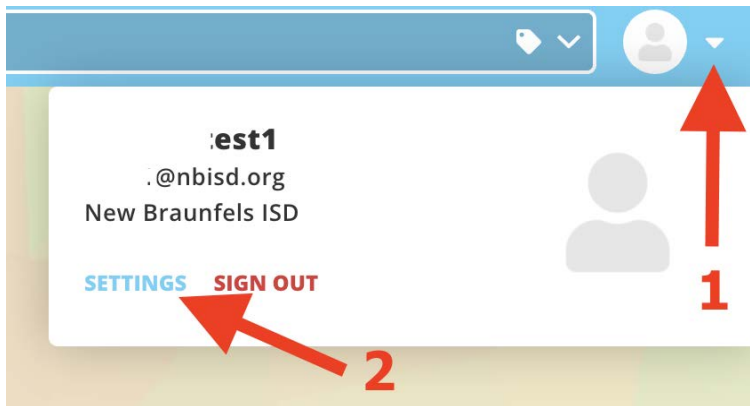

3. Select **Recovery** then **Reset Password**

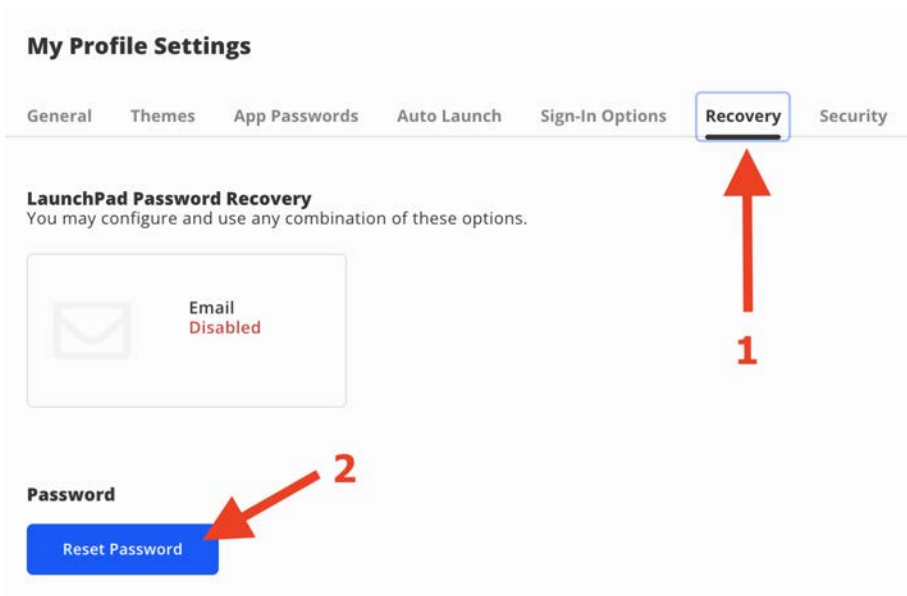

4. Type in your old password and then type in your new password, **Select Save.**

The screenshot shows a web interface for password recovery. At the top left, there is a blue arrow pointing left and the word "Recovery". Below this is a grey bar with a large red number "1". The main form area contains three password input fields, each with a "toggle visibility" icon (an eye with a slash) on the right. The fields are labeled "Old Password", "New Password", and "Confirm Password". The "Confirm Password" field has a blue border. A red box highlights all three input fields. At the bottom of the form, there is a "Go Back" button on the left and a green "Save" button on the right. A red number "2" with a red arrow points to the "Save" button.

5. The next time you log into Classlink, Canvas, or a computer you will need to use your **NEW** password.